

TP|T|TB|TF Door mounting switch

1P up to 12P

Size 0
A 10|12|16|20|25|32



Technical information



According to IEC 60947-3
UL508 - CAN/CSA C22.2 N° 14

According to IEC 60947-3		TP10	T12	T20	TB20	TB25	TB32	TF12	TF16	TF25
Rated thermal current	Ith	A 12	16	25	20	25	32	20	25	32
Rated insulation voltage	Ui	V 500	500	500	500	500	500	690	690	690
Rated impulse withstand voltage	Uimp	kV 4	6	6	4	4	4	6	6	6
AC rated operational current	Ue 415V AC13A	A 10	-	-	-	-	-	-	-	-
	Ue 415V AC21A	A 12	16	25	20	25	32	20	25	32
	Ue 415V AC22A	A 12	16	25	20	25	32	20	25	32
AC rated operational current	Ue 415V AC23A	A 10	10	25	20	25	32	8	16	20
		kA 5	10	10	5	5	5	5	5	5
Rated conditional short-circuit current	kA	5	10	10	5	5	5	5	5	5
Rated maximum current	gL-gG	A 16	25	25	35	35	35	20	25	32
Rated breaking capacity	400V; cos φ=0,45	A 80	80	100	160	200	256	100	160	200
Rated short-time withstand current (1 sec)	A	100	240	400	240	400	500	350	400	500
Mechanical durability (according to the standards, for other values please consult)		1000	10000	10000	10000	10000	10000	10000	10000	10000
Rigid copper conductor	mm ²	2x4	2x4	2x4	1x10 2x6	1x10 2x6	1x10 2x6	1x10	1x10	1x10
Flexible copper conductor	mm ²	2x2,5	2x2,5	2x2,5	1x6 2x4	1x6 2x4	1x6 2x4	1x6	1x6	1x6
According to UL508 - CAN / CSA C22.2 N° 14		T12	T20	TF12	TF16	TF25				
Rated thermal current	Ith	A -	12	20	-	-	16	20	25	
General use rating	Vac	-	300	300	-	-	600	600	600	
AC rated operational power	3x240V	HP -	2	5	-	-	2	5	7,5	
	3x480V	HP -	-	-	-	-	5	10	12	
	3x600V	HP -	-	-	-	-	5	10	15	

Normal service conditions:
Ambient air temperature (°C): -5°...+40°. Maximum altitude: 2.000 m. Maximum humidity: 90%. Pollution degree: 3 (standard for industrial applications). Rated frequency at AC utilization categories: 50/60 Hz.
Rated duties at utilization categories AC21A, AC22A and AC23A: Continuing (8 hours); uninterrupted.



Series | Amp

- TP-0010
- T-00012
- T-00020
- TB-0020
- TB-0025
- TB-0032
- TF-0012
- TF-0016
- TF-0025

Diagram

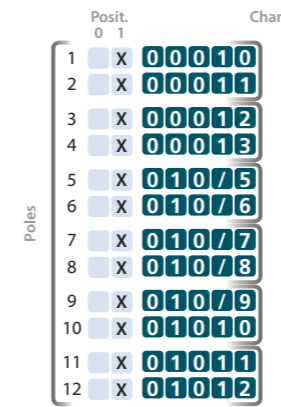

Type

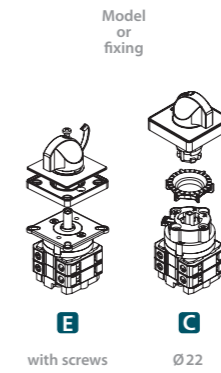
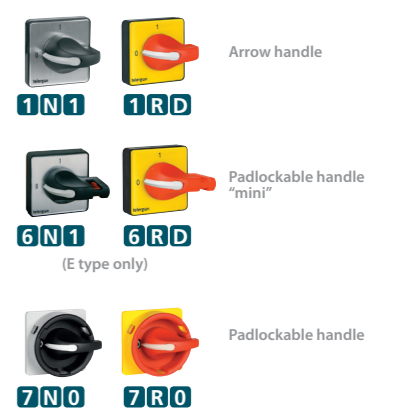
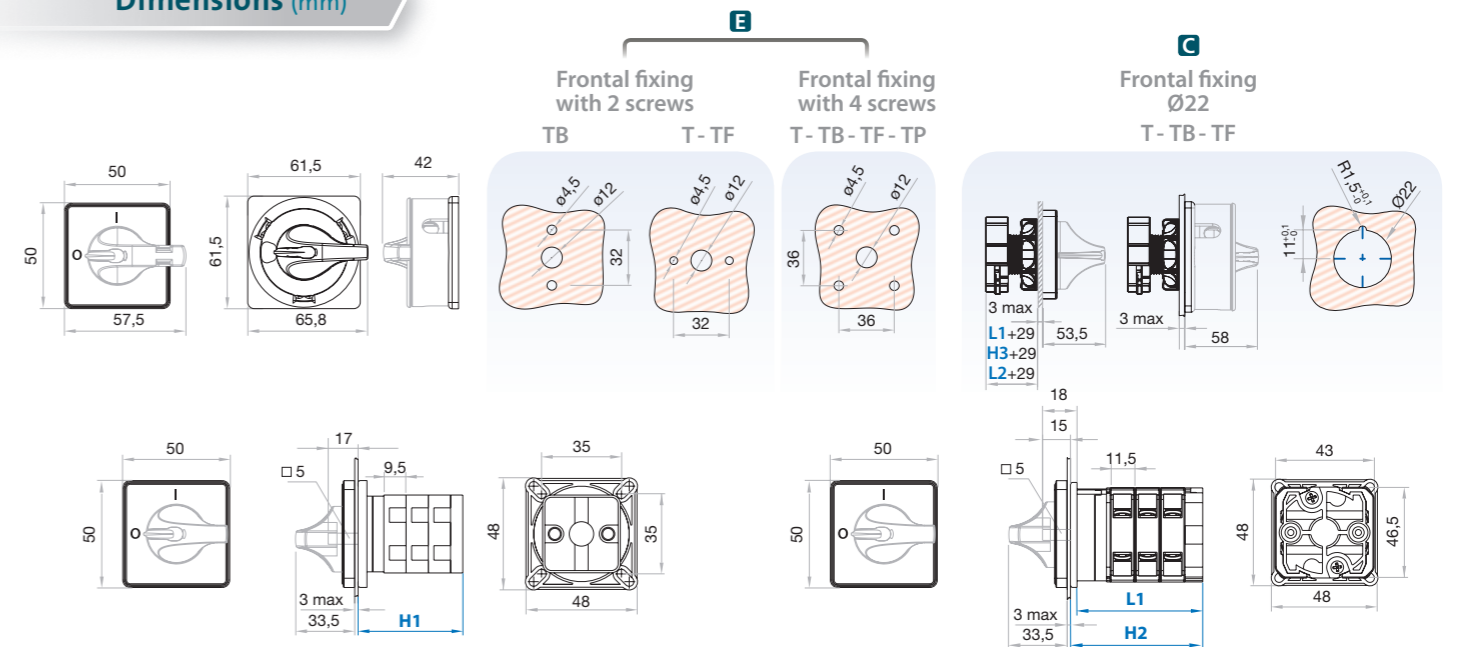

Plate and handle



Dimensions (mm)



TP series	Chambers	1	2	3	4	5	6
H1		26,8	36,3	45,8	55,3	64,8	74,3

T series	Chambers	1	2	3	4	5	6
L1		34,5	46	57,5	69	80,5	92
H2		37,5	49	60,5	72	83,5	95

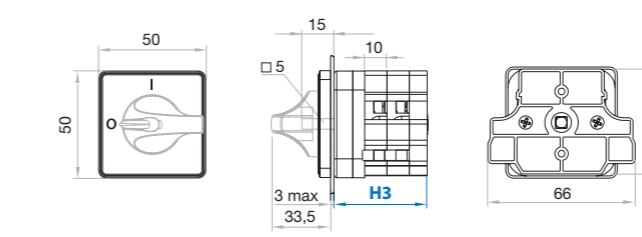

TB series	Chambers	1	2	3	4	5	6
H3		31,5	41,5	51,5	61,5	71,5	81,5

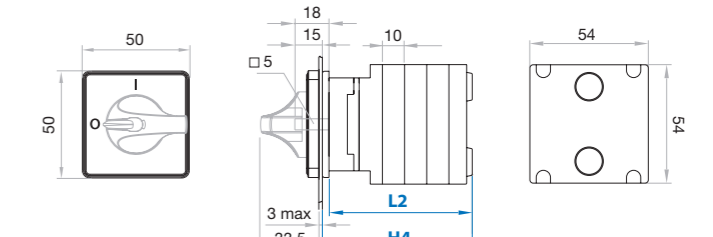

TF series	Chambers	1	2	3	4	5	6
L2		45	55	65	75	85	95
H4		48	58	68	78	88	98

T|TB|TF Base mounting switch with clutch device 1P up to 12P

Size 0
A 12|16|20|25|32



Technical information



According to IEC 60947-3
UL508 - CAN/CSA C22.2 N° 14

According to IEC 60947-3		T12	T20	TB20	TB25	TB32	TF12	TF16	TF25		
Rated thermal current	Ith	A	16	25	20	25	32	20	25	32	
Rated insulation voltage	Ui	V	500	500	500	500	500	690	690	690	
Rated impulse withstand voltage	Uimp	kV	6	6	4	4	4	6	6	6	
AC rated operational current	Ie	Ue 415V AC13A	A	-	-	-	-	-	-	-	
		Ue 415V AC21A	A	16	25	20	25	32	20	25	32
		Ue 415V AC22A	A	16	25	20	25	32	20	25	32
		Ue 415V AC23A	A	10	25	20	25	32	8	16	20
Rated conditional short-circuit current		kA	10	10	5	5	5	5	5	5	
Rated maximum current	gL-gG	A	25	25	35	35	35	20	25	32	
Rated breaking capacity	400V; cos φ=0,45	A	80	100	160	200	256	100	160	200	
Rated short-time withstand current (1 sec)		A	240	400	240	400	500	350	400	500	
Mechanical durability (according to the standards, for other values please consult)			10000	10000	10000	10000	10000	10000	10000	10000	
Rigid copper conductor		mm ²	2x4	2x4	1x10 2x6	1x10 2x6	1x10 2x6	1x10	1x10	1x10	
Flexible copper conductor		mm ²	2x2,5	2x2,5	1x6 2x4	1x6 2x4	1x6 2x4	1x6	1x6	1x6	
According to UL508 - CAN / CSA C22.2 N° 14			T12	T20			TF12	TF16	TF25		
Rated thermal current	Ith	A	12	20	-	-	16	20	25		
General use rating		Vac	300	300	-	-	600	600	600		
AC rated operational power	3x240V	HP	2	5	-	-	2	5	7,5		
	3x480V	HP	-	-	-	-	5	10	12		
	3x600V	HP	-	-	-	-	5	10	15		

Normal service conditions:

Ambient air temperature (°C): -5°...+40°. Maximum altitude: 2.000 m. Maximum humidity: 90%. Pollution degree: 3 (standard for industrial applications). Rated frequency at AC utilization categories: 50/60 Hz.

Rated duties at utilization categories AC21A, AC22A and AC23A: Continuing (8 hours); uninterrupted.

Dimensions (mm)

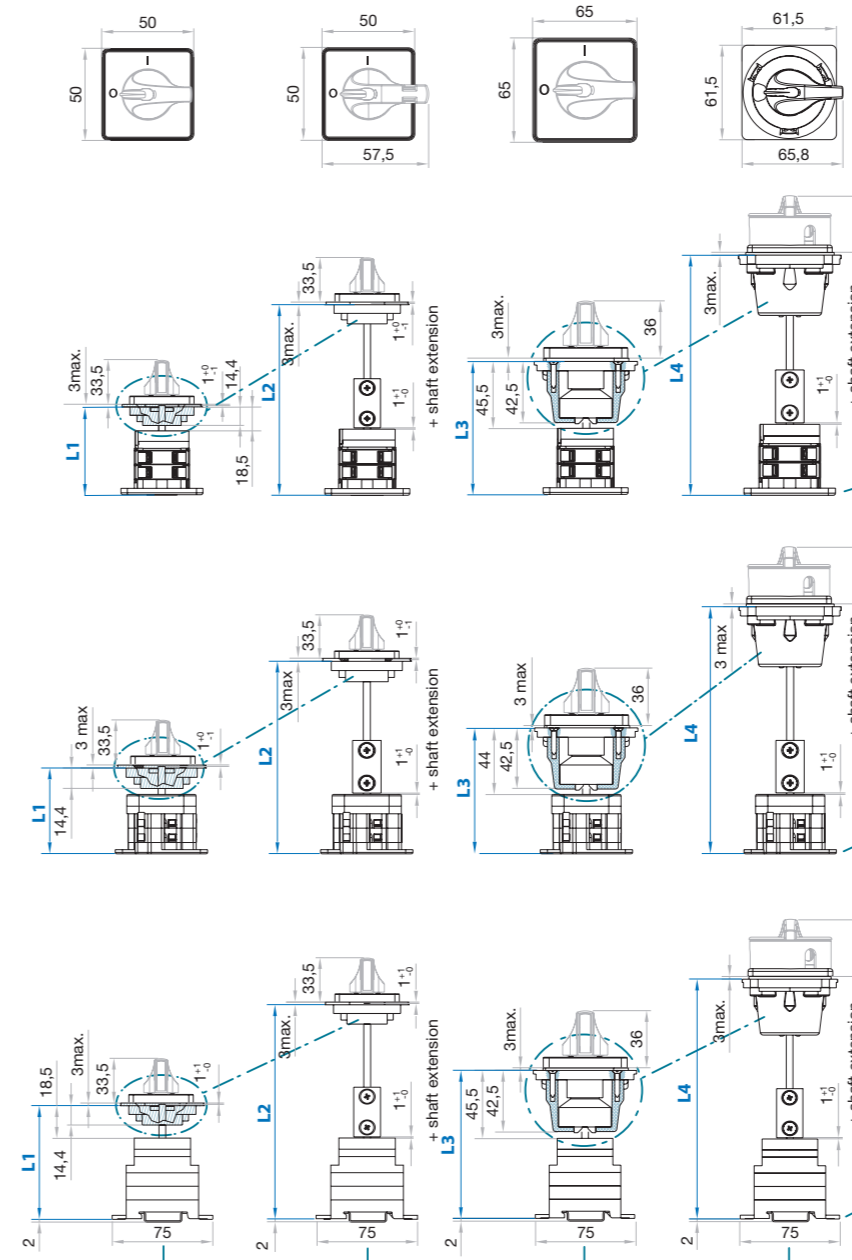

Series | Amp

- T-00012
- T-00020
- TB-0020
- TB-0025
- TB-0032
- TF-0012
- TF-0016
- TF-0025

Diagram

Posit.	0	1	Chambers
1	X	00010	1
2	X	00011	1
3	X	00012	2
4	X	00013	2
5	X	01075	3
6	X	01076	3
7	X	01077	4
8	X	01078	4
9	X	01079	5
10	X	01010	5
11	X	01011	6
12	X	01012	6

Type



Plate and handle



Frontal panel mechanization with 2 or 4 screws
L1-L2

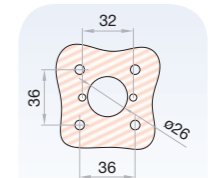

Frontal panel mechanization with 2 or 4 screws
L3-L4

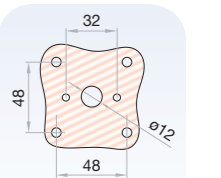

T series	Chambers	1	+	1	+	1	+	1	+
		L1	L2	L3	L4				
min		56	+11,5	94	+11,5	83	+11,5	121	+11,5
max				256				283	

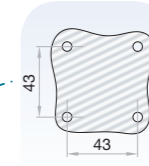

L2-L4
Specify length when ordering

TB series	Chambers	1	+	1	+	1	+	1	+
		L1	L2	L3	L4				
min		46	+10	84	+10	75,5	+10	113	+10
max				246				275,5	

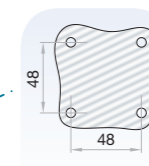

L2-L4
Specify length when ordering

TF series	Chambers	1	+	1	+	1	+	1	+
		L1	L2	L3	L4				
min		65,5	+10	103,5	+10	92,5	+10	130,5	+10
max				265,5				292,5	

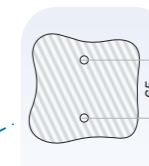

L2-L4
Specify length when ordering

IEC60715/TH35-7,5
DIN46277

> For more information on this series; see downloadable document about accessories and General Information of the series

T Door mounting switch

1P up to 12P

Size 1
A 16|25|32|40



T

Technical information



According to IEC 60947-3
UL508 - CAN/CSA C22.2 N° 14

According to IEC 60947-3		T16	T25	T32	T40	
Rated thermal current	I _{th}	A	25	32	40	50
Rated insulation voltage	U _i	V	690	690	690	690
Rated impulse withstand voltage	U _{imp}	kV	6	6	8	8
AC rated operational current	U _e 415V AC21A	A	25	32	40	50
	U _e 415V AC22A	A	25	32	40	50
	U _e 415V AC23A	A	16	20	25	32
Rated conditional short-circuit current		kA	10	10	10	10
Rated maximum current	gL-gG	A	32	32	50	50
Rated breaking capacity	400V; cos φ=0,45	A	160	200	256	320
Rated short-time withstand current (1 sec)		A	500	650	800	800
Mechanical durability (according to the standards, for other values please consult)			10000	10000	10000	10000
Rigid copper conductor		mm ²	2x6	2x6	2x10	2x10
Flexible copper conductor		mm ²	2x4	2x4	2x6	2x6
According to UL508 - CAN / CSA C22.2 N° 14		T16	T25	T32	T40	
Rated thermal current	I _{th}	A	16	25	32	40
General use rating		Vac	600	600	600	600
	3x240V	HP	5	7,5	10	15
	3x480V	HP	10	15	20	25
AC rated operational power		HP	10	15	20	25
	3x600V	HP	10	15	20	25

Normal service conditions:

Ambient air temperature (°C): -5°...+40°. Maximum altitude: 2.000 m. Maximum humidity: 90%. Pollution degree: 3 (standard for industrial applications). Rated frequency at AC utilization categories: 50/60 Hz.
Rated duties at utilization categories AC21A, AC22A and AC23A: Continuing (8 hours); uninterrupted.



Series | Amp

T-00016
T-00025
T-00032
T-00040

Diagram

Posit.	0	1	Chambers
1	X	00010	1
2	X	00011	1
3	X	00012	2
4	X	00013	2
5	X	01075	3
6	X	01076	3
7	X	01077	4
8	X	01078	4
9	X	01079	5
10	X	01010	5
11	X	01011	6
12	X	01012	6

Type

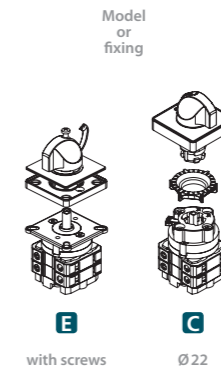
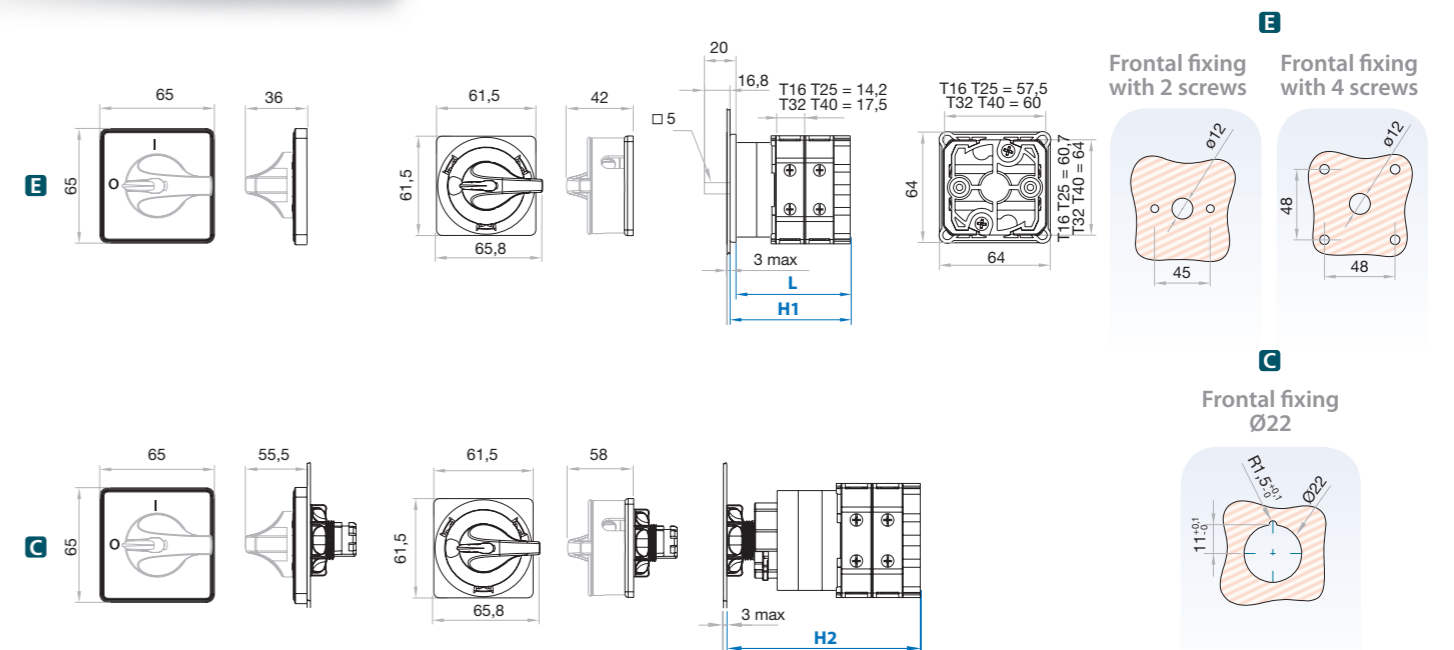

Plate and handle



Dimensions (mm)



T series	Chambers	1	2	3	4	5	6
T16 T25	L	46,4	60,6	74,8	89	103,2	117,4
	H1	49,6	63,8	78	92,2	106,4	120,6
T32 T40	H2	75,5	89,5	103,7	117,9	132,1	146,3
	L	49,8	67,3	84,8	102,3	119,8	137,3
T32 T40	H1	53	70,5	88	105,5	123	140,5
	H2	78,8	96,3	113,8	131,3	148,8	166,3

T Base mounting switch with clutch device 1P up to 12P

Size 1
A 16|25|32|40



T

Technical information



According to IEC 60947-3
UL508 - CAN/CSA C22.2 N° 14

According to IEC 60947-3			T16	T25	T32	T40	
Rated thermal current	Ith	A	25	32	40	50	
Rated insulation voltage	Ui	V	690	690	690	690	
Rated impulse withstand voltage	Uimp	kV	6	6	8	8	
AC rated operational current	Ie	Ue 415V AC21A	A	25	32	40	50
		Ue 415V AC22A	A	25	32	40	50
		Ue 415V AC23A	A	16	20	25	32
Rated conditional short-circuit current		kA	10	10	10	10	
Rated maximum current	gL-gG	A	32	32	50	50	
Rated breaking capacity	400V; cos φ=0,45	A	160	200	256	320	
Rated short-time withstand current (1 sec)		A	500	650	800	800	
Mechanical durability (according to the standards, for other values please consult)			10000	10000	10000	10000	
Rigid copper conductor		mm ²	2x6	2x6	2x10	2x10	
Flexible copper conductor		mm ²	2x4	2x4	2x6	2x6	
According to UL508 - CAN / CSA C22.2 N° 14			T16	T25	T32	T40	
Rated thermal current	Ith	A	16	25	32	40	
General use rating		Vac	600	600	600	600	
		3x240V	HP	5	7,5	10	15
		3x480V	HP	10	15	20	25
AC rated operational power		3x600V	HP	10	15	20	25

Normal service conditions:

Ambient air temperature (°C): -5°...+40°. Maximum altitude: 2.000 m. Maximum humidity: 90%. Pollution degree: 3 (standard for industrial applications). Rated frequency at AC utilization categories: 50/60 Hz.
Rated duties at utilization categories AC21A, AC22A and AC23A: Continuing (8 hours); uninterrupted.

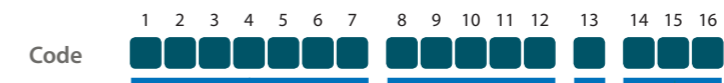

Series | Amp

- T-00016
- T-00025
- T-00032
- T-00040

Diagram

Posit.	0	1	Chambers
1	X	00010	1
2	X	00011	1
3	X	00012	2
4	X	00013	2
5	X	01075	3
6	X	01076	3
7	X	01077	4
8	X	01078	4
9	X	01079	5
10	X	01010	5
11	X	01011	6
12	X	01012	6

Type

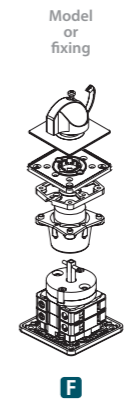
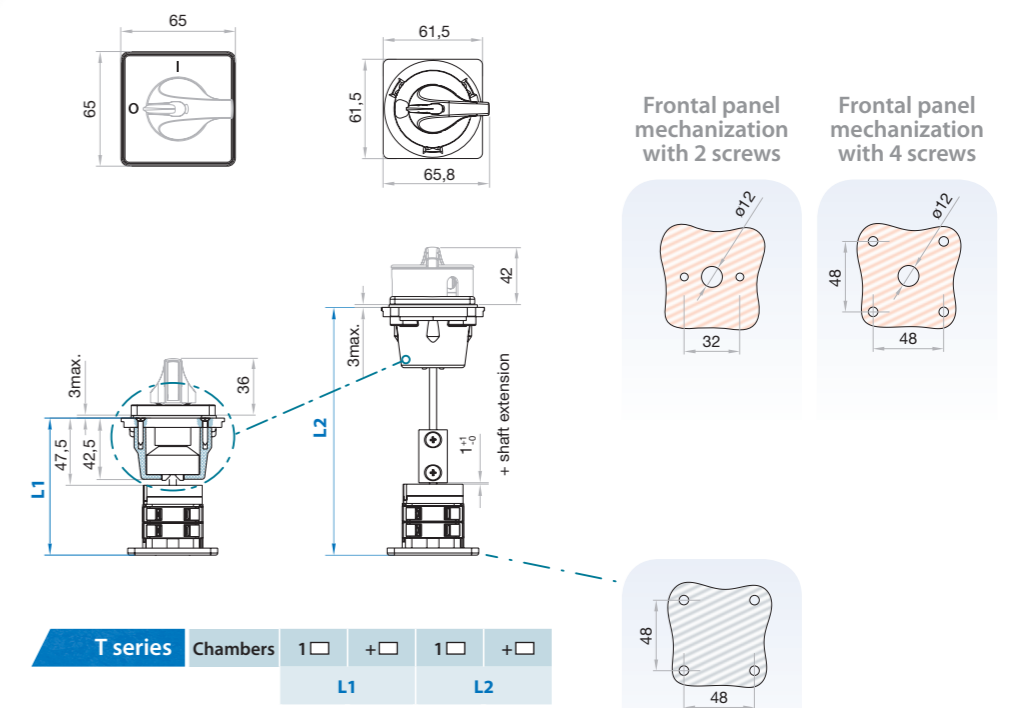

Plate and handle



Dimensions (mm)



T series	Chambers	1 □	+ □	1 □	+ □
		L1		L2	
T16 T25	min	97,1	+14,2	135,1	+14,2
	max			297,1	
T32 T40	min	100,5	+17,5	138,5	+17,5
	max			300,5	

L2 Specify length when ordering

T Door mounting switch

1P up to 12P

Size 2
A 50|63|80|100|125|175



* Except T175

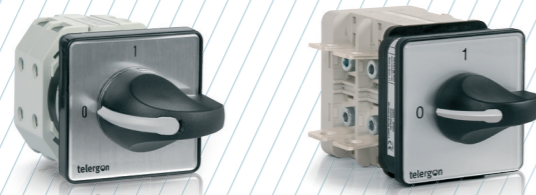

T

Technical information



According to IEC 60947-3
UL508 - CAN/CSA C22.2 N° 14

According to IEC 60947-3		T50	T63	T80	T100	T125	T175
Rated thermal current	Ith	A	63	80	80	125	200
Rated insulation voltage	Ui	V	690	690	690	690	1000
Rated impulse withstand voltage	Uimp	kV	8	8	8	8	8
AC rated operational current	Ie	Ue 415V AC21A	A	63	80	80	115
		Ue 415V AC22A	A	63	80	80	115
		Ue 415V AC23A	A	63	63	63	100
Rated conditional short-circuit current		kA	15	15	15	15	15 ^(*)
Rated maximum current	gL-gG	A	80	80	80	125	160
Rated breaking capacity	400V; cos φ=0,45	A	504	504	504	640	1600
Rated short-time withstand current (1 sec)		A	1600	1600	1600	2500	3500
Mechanical durability (according to the standards, for other values please consult)			10000	10000	10000	8000	8000
Rigid copper conductor		mm ²	16/25 ^(*)	16/25 ^(*)	16/25 ^(*)	35/50 ^(*)	35/50 ^(*)
Flexible copper conductor		mm ²	10/16 ^(*)	10/16 ^(*)	10/16 ^(*)	16/35 ^(*)	16/35 ^(*)
According to UL508 - CAN / CSA C22.2 N° 14		T50	T63	T80	T100	T125	T175
Rated thermal current	Ith	A	63	63	63	100	200
General use rating	Vac		600	600	600	600	600
	HP		20	20	20	30	25
AC rated operational power	3x240V	HP	40	40	40	50	60
	3x600V	HP	40	40	40	50	50

*⁽¹⁾ With terminals for connection

*⁽²⁾ Mounting without connection terminals or terminals + phase barriers DT-90025

Normal service conditions:

Ambient air temperature (°C): -5°...+40°. Maximum altitude: 2.000 m. Maximum humidity: 90%. Pollution degree: 3 (standard for industrial applications). Rated frequency at AC utilization categories: 50/60 Hz.

Rated duties at utilization categories AC21A, AC22A and AC23A: Continuing (8 hours); uninterrupted.



Series | Amp

T-00050
T-00063
T-00080
T-00100
T-00125
T-00175

Diagram

Posit.	0	1	Chambers
1	X	00010	1
2	X	00011	1
3	X	00012	2
4	X	00013	2
5	X	01075	3
6	X	01076	3
7	X	01077	4
8	X	01078	4
9	X	01079	5
10	X	01010	5
11	X	01011	6
12	X	01012	6

Type

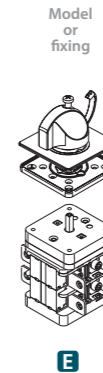
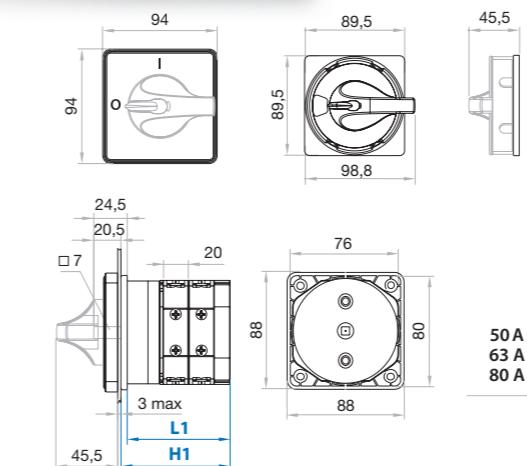

Plate and handle



Dimensions (mm)



T series	Chambers	1	2	3	4	5	6
T50 T63 T80	L1	58,5	78,5	98,5	118,5	138,5	158,5
	H1	62,5	82,5	102,5	122,5	142,5	162,5

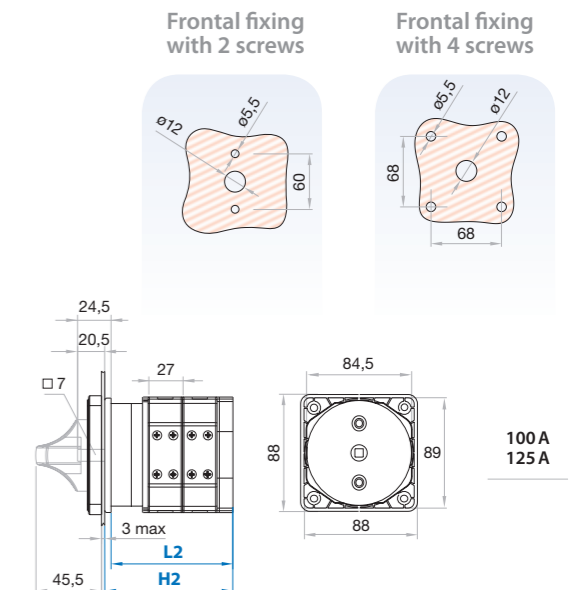

T series	Chambers	1	2	3	4	5	6
T100 T125	L2	67	94	121	148	175	202
	H2	71	98	125	152	179	206

UL Terminal Lug

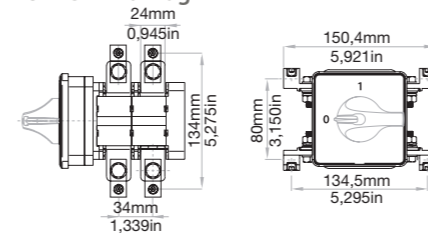

Terminal extensions according to UL

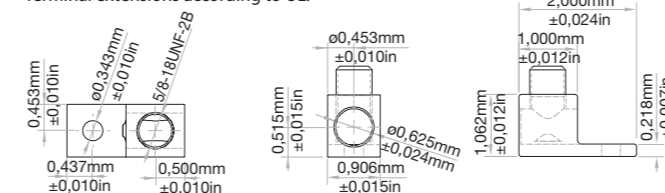

Wire size	Wires per lug	Wire type	Kit reference
120 mm ² / 250 kcmil	1	Cu	DS-TLU21 (2 pieces)

Note: The hardware needed to complete the wiring is supplied as standard.

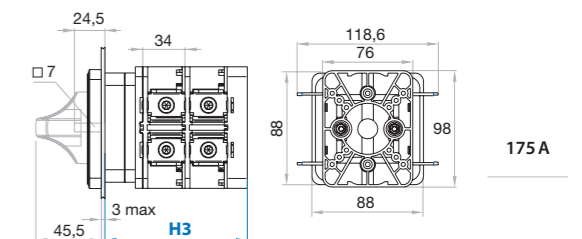

T series	Chambers	1	2	3	4	5	6
T175	H3	80,8	114,8	148,8	182,8	216,8	250,8

For more information on this series; see downloadable document about accessories and General Information of the series

T Base mounting switch with clutch device 1P up to 12P

Size 2
A 50|63|80|100|125|175

* Except T175

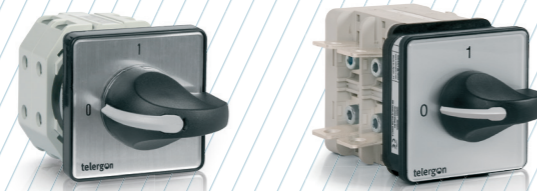

T

Technical information



According to IEC 60947-3
UL508 - CAN/CSA C22.2 N° 14

According to IEC 60947-3		T50	T63	T80	T100	T125	T175	
Rated thermal current	Ith	A	63	80	80	125	200	
Rated insulation voltage	Ui	V	690	690	690	690	1000	
Rated impulse withstand voltage	Uimp	kV	8	8	8	8	8	
AC rated operational current	Ie	Ue 415V AC21A	A	63	80	80	115	200
		Ue 415V AC22A	A	63	80	80	115	200
		Ue 415V AC23A	A	63	63	63	100	200
Rated conditional short-circuit current		kA	15	15	15	15	15 ⁽¹⁾	
Rated maximum current	gL-gG	A	80	80	80	125	160	
Rated breaking capacity	400V; cos φ=0,45	A	504	504	504	640	1600	
Rated short-time withstand current (1 sec)		A	1600	1600	1600	2500	3500	
Mechanical durability (according to the standards, for other values please consult)			10000	10000	10000	8000	8000	
Rigid copper conductor		mm ²	16/25 ⁽¹⁾	16/25 ⁽¹⁾	16/25 ⁽¹⁾	35/50 ⁽¹⁾	35/50 ⁽¹⁾	
Flexible copper conductor		mm ²	10/16 ⁽¹⁾	10/16 ⁽¹⁾	10/16 ⁽¹⁾	16/35 ⁽¹⁾	16/35 ⁽¹⁾	
According to UL508 - CAN / CSA C22.2 N° 14		T50	T63	T80	T100	T125	T175	
Rated thermal current	Ith	A	63	63	100	100	200	
General use rating		Vac	600	600	600	600	600	
		3x240V	HP	20	20	20	30	25
		3x480V	HP	40	40	40	50	60
AC rated operational power		3x600V	HP	40	40	40	50	

⁽¹⁾ With terminals for connection

⁽²⁾ Mounting without connection terminals or terminals + phase barriers DT-90025

Normal service conditions:

Ambient air temperature (°C): -5°...+40°. Maximum altitude: 2.000 m. Maximum humidity: 90%. Pollution degree: 3 (standard for industrial applications). Rated frequency at AC utilization categories: 50/60 Hz.

Rated duties at utilization categories AC21A, AC22A and AC23A: Continuing (8 hours); uninterrupted.

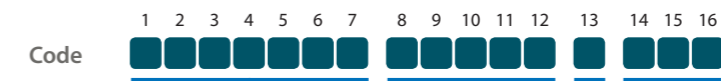

Series | Amp

- T-00050
- T-00063
- T-00080
- T-00100
- T-00125
- T-00175

Diagram

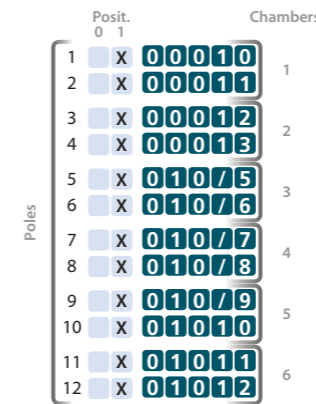

Type

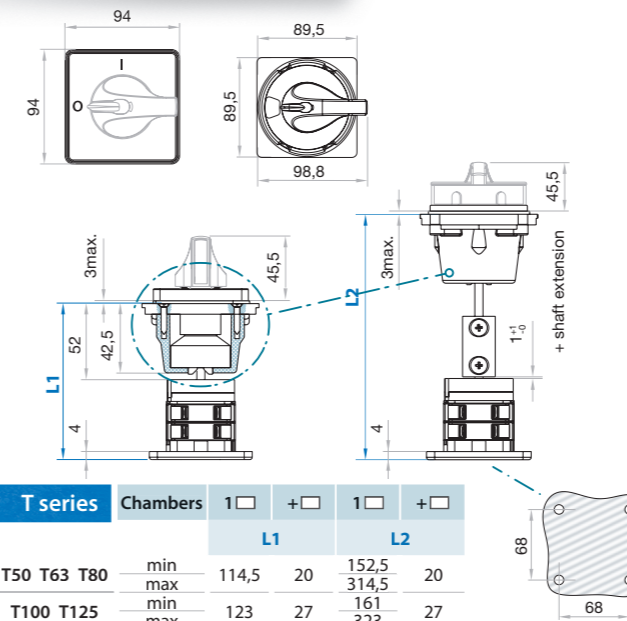

Plate and handle



Frontal panel mechanization with 2 screws
Frontal panel mechanization with 4 screws

Dimensions (mm)



T series	Chambers	1	+	1	+
		L1		L2	
T50 T63 T80	min	114,5	20	152,5	20
	max			314,5	
T100 T125	min	123	27	161	27
	max			323	

L2 Specify length when ordering

DIN rail support

Code DT-90421 (1 unit)

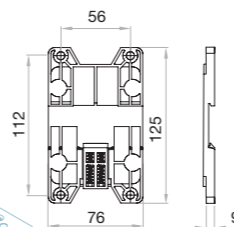

IEC60715/TH35-7,5
DIN46277

DIN rail or 4 screws included in the D or F fixing T175 types. The maximum number of chambers advisable is 3, for further conditions please consult

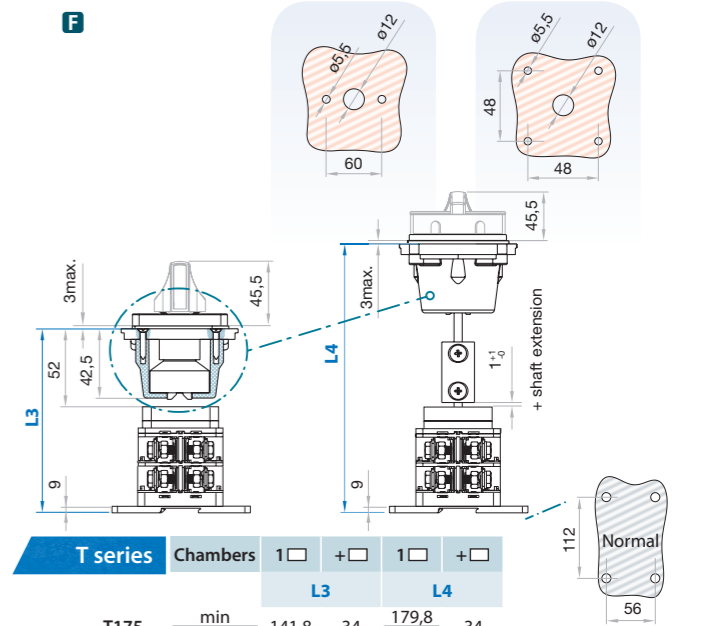

T series	Chambers	1	+	1	+
		L3		L4	
T175	min	141,8	34	179,8	34
	max			341,8	

L4 Specify length when ordering

UL Terminal Lug

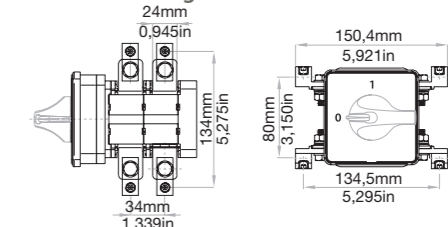

Terminal extensions according to UL.

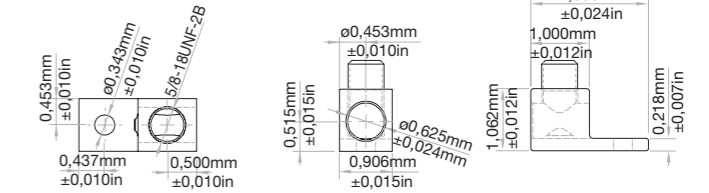

Wire size	Wires per lug	Wire type	Kit reference
120 mm ² / 250 kcmil	1	Cu	DS-TLU21 (2 pieces)

Note: The hardware needed to complete the wiring is supplied as standard.

> For more information on this series; see downloadable document about accessories and General Information of the series

T Door mounting switch

1P up to 12P

Size 3
200|250|315

* Under request also available in 400A, 500A, 630A, 800A, consult please



T

Technical information



According to IEC 60947-3
UL508 - CAN/CSA C22.2 N° 14

According to IEC 60947-3			T200	T250	T315	
Rated thermal current	Ith	A	200	250	315	
Rated insulation voltage	Ui	V	690	690	690	
Rated impulse withstand voltage	Uimp	kV	8	8	8	
AC rated operational current	Ie	Ue 415V AC21A	A	200	250	
		Ue 415V AC22A	A	200	250	
		Ue 415V AC23A	A	200	200	
Rated conditional short-circuit current		kA	15	15	15	
Rated maximum current	gL-gG	A	200	250	315	
Rated breaking capacity	400V; cos φ=0,45	A	1450	2000	2240	
Rated short-time withstand current (1 sec)		A	4400	4400	4400	
Mechanical durability (according to the standards, for other values please consult)			8000	8000	8000	
Rigid copper conductor		mm ²	95	120	185	
Flexible copper conductor		mm ²	95	120	185	
According to UL508 - CAN / CSA C22.2 N° 14			T200	T250	T315	
Rated thermal current	Ith	A	200	200	200	
General use rating		Vac	600	600	600	
		3x240V	HP	60	60	60
		3x480V	HP	75	75	75
AC rated operational power		3x600V	HP	60	60	

Normal service conditions:

Ambient air temperature (°C): -5°...+40°. Maximum altitude: 2.000 m. Maximum humidity: 90%. Pollution degree: 3 (standard for industrial applications). Rated frequency at AC utilization categories: 50/60 Hz.
Rated duties at utilization categories AC21A, AC22A and AC23A: Continuing (8 hours); uninterrupted.



Series | Amp

T-00200
T-00250
T-00315

Diagram

Posit.	0	1	Chambers
1	X	00010	1
2	X	00011	1
3	X	00012	2
4	X	00013	2
5	X	01075	3
6	X	01076	3
7	X	01077	4
8	X	01078	4
9	X	01079	5
10	X	01010	5
11	X	01011	6
12	X	01012	6

Type

Model or fixing

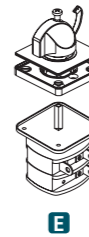

E

Plate and handle

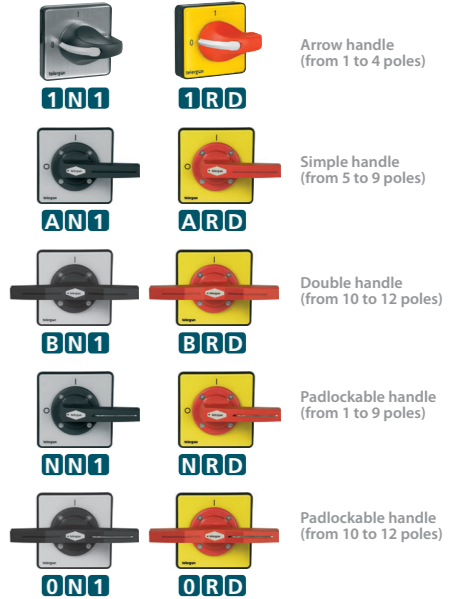

Dimensions (mm)

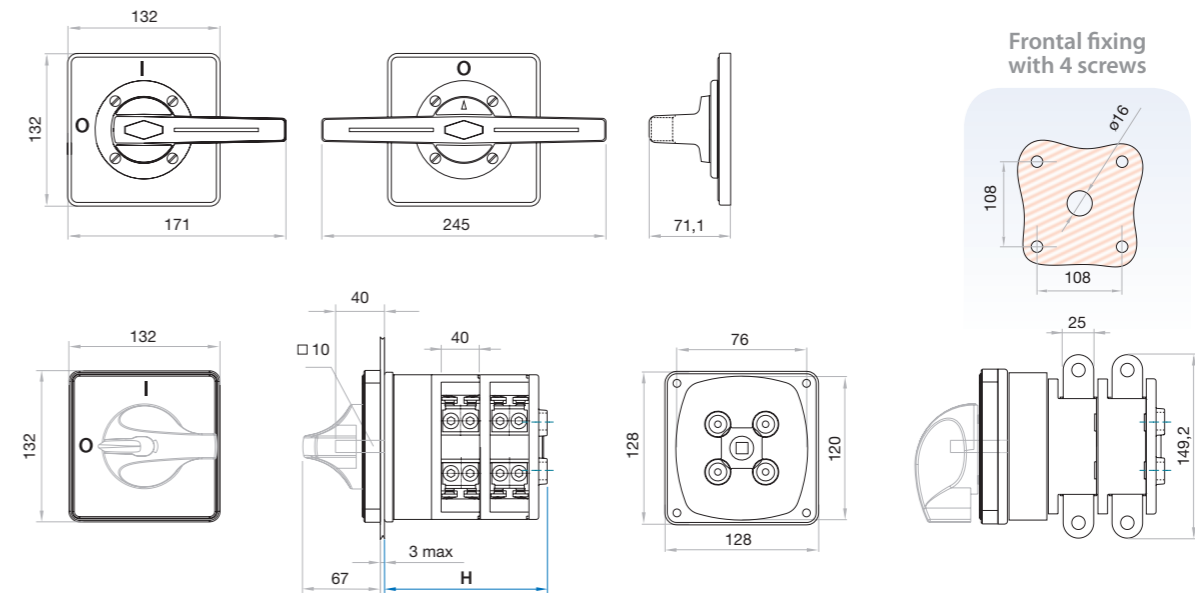

UL Terminal Lug

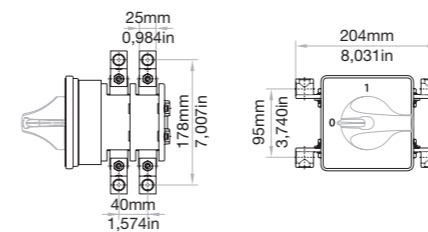

Terminal extensions according to UL

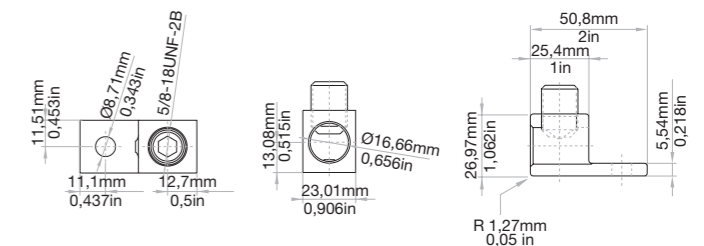

T series	Chambers	1	2	3	4	5	6
T200 T250 T315	H	95	135	175	215	255	295

Wire size	Wires per lug	Wire type	Kit reference
150 mm ² / 300 kcmil	1	Cu/Al	DS-TL01 (2 pieces)

Note: The hardware needed to complete the wiring is supplied as standard.

T Base mounting switch with clutch device

1P up to 12P



Size 3
A* 200|250|315

* Under request also available in 400A, 500A, 630A, 800A, consult please

Technical information



According to IEC 60947-3
UL508 - CAN/CSA C22.2 N° 14

According to IEC 60947-3			T200	T250	T315	
Rated thermal current	I _{th}	A	200	250	315	
Rated insulation voltage	U _i	V	690	690	690	
Rated impulse withstand voltage	U _{imp}	kV	8	8	8	
AC rated operational current	I _e	U _e 415V AC21A	A	200	315	
		U _e 415V AC22A	A	200	250	315
		U _e 415V AC23A	A	200	200	200
Rated conditional short-circuit current		kA	15	15	15	
Rated maximum current	gL-gG	A	200	250	315	
Rated breaking capacity	400V; cos φ=0,45	A	1450	2000	2240	
Rated short-time withstand current (1 sec)		A	4400	4400	4400	
Mechanical durability (according to the standards, for other values please consult)			8000	8000	8000	
Rigid copper conductor		mm ²	95	120	185	
Flexible copper conductor		mm ²	95	120	185	
According to UL508 - CAN / CSA C22.2 N° 14			T200	T250	T315	
Rated thermal current	I _{th}	A	200	200	200	
General use rating		Vac	600	600	600	
		3x240V	HP	60	60	60
		3x480V	HP	75	75	75
AC rated operational power		3x600V	HP	60	60	

Normal service conditions:

Ambient air temperature (°C): -5°...+40°. Maximum altitude: 2.000 m. Maximum humidity: 90%. Pollution degree: 3 (standard for industrial applications). Rated frequency at AC utilization categories: 50/60 Hz.
Rated duties at utilization categories AC21A, AC22A and AC23A: Continuing (8 hours); uninterrupted.



Series | Amp

T-00200
T-00250
T-00315

Diagram

Posit.	0	1	Chambers
1	X	00010	1
2	X	00011	2
3	X	00012	3
4	X	00013	4
5	X	01075	5
6	X	01076	6
7	X	01077	7
8	X	01078	8
9	X	01079	9
10	X	01010	10
11	X	01011	11
12	X	01012	12

Type

Model or fixing

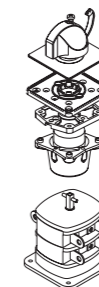

F

Plate and handle

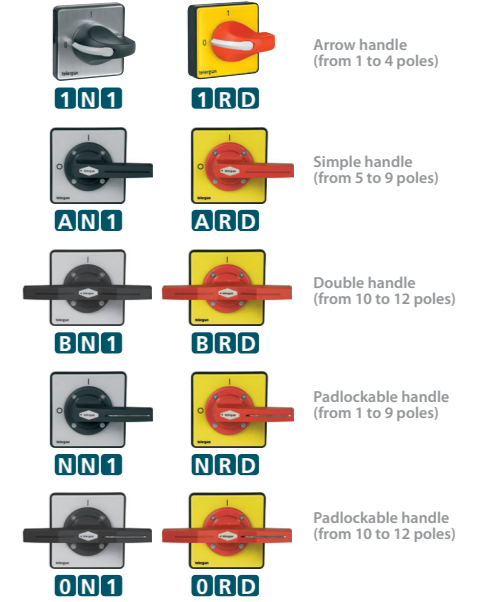

Dimensions (mm)

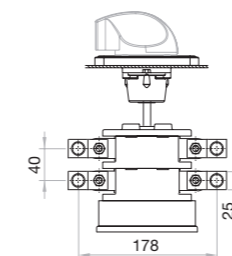
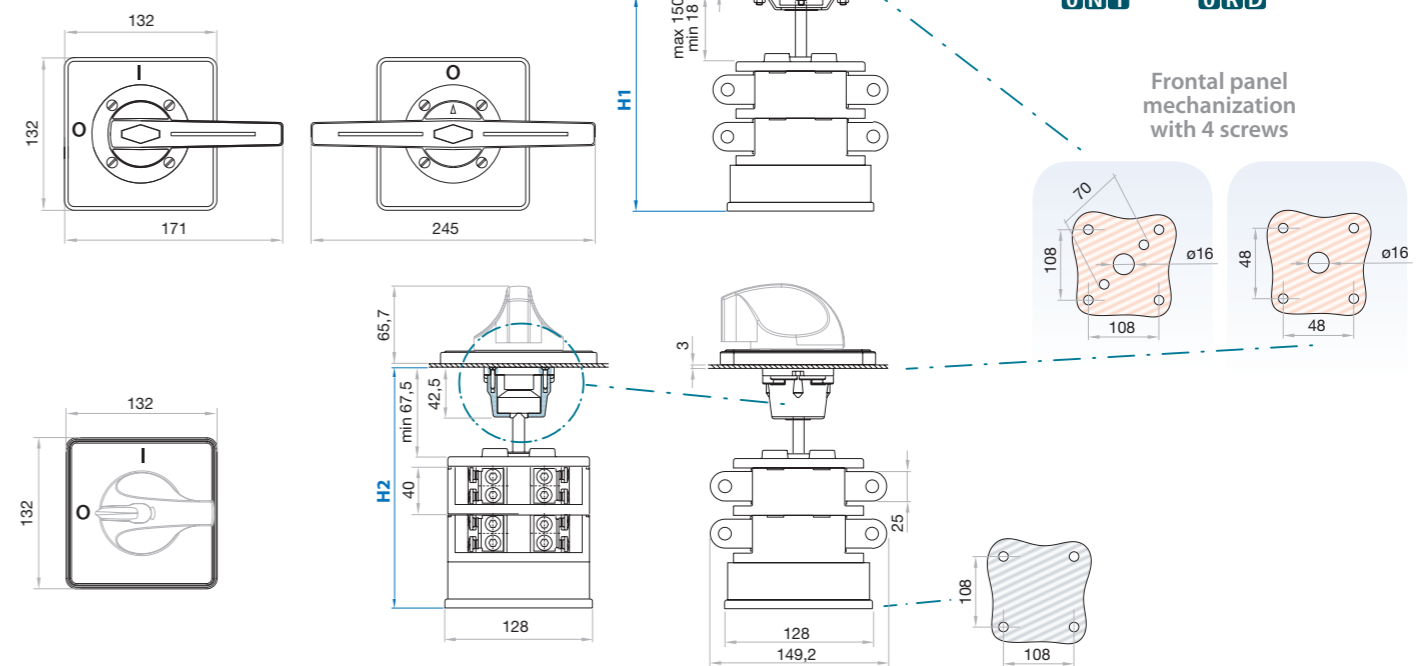

UL Terminal Lug

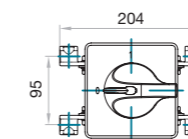

Terminal extensions according to UL.

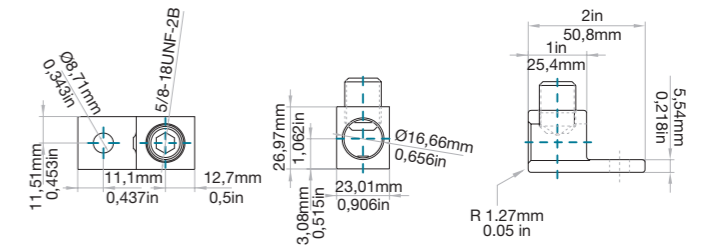

T series	Chambers	1	2	3	4	5	6
T200	H1	139,3	179,3	219,3	259,3	299,3	339,3
T250	H2	162,5	202,5	242,5	282,5	322,5	362,5
T315							

Wire size	Wires per lug	Wire type	kit reference
150 mm ² / 300 kcmil	1	Cu/Al	DS-TL01 (2 pieces)

Note: The hardware needed to complete the wiring is supplied as standard.

H1-H2
Specify length when ordering

For more information on this series; see downloadable document about accessories and General Information of the series