



# S5M DC Switch - disconnecter for DC current 4P+4P

**Size 2**  
**A** 500|630  
 1500Vdc



CODE-500A **S5M063044R0**

CODE-630A **S5M080044C0**

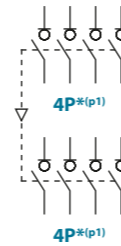

## Accessories



» **Direct handle**  
 CODE DS-LI22



» **External handle** included shaft<sup>\*(e1)</sup>  
 IP65  
 CODE DS-LA22

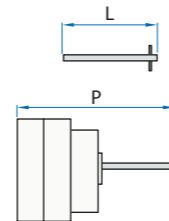

» **Shafts**  
**Standard shaft** included <sup>\*(e1)</sup>  
 L (mm) | P (mm)  
 239 | 325... 490



» **Auxiliary contacts**  
 1NO+1NC CODE DS-AU11  
 2NO+2NC CODE DS-AU12  
 I<sub>e</sub> = 16 A (resistive loads)  
 4 A (inductive loads) at 250 Vac.



» **Bridging links<sup>\*(p1)</sup>**  
**A** 500A CODE DS-PI230L (2 units)  
**B** 630A CODE DS-PI2D (2 units)

<sup>\*(p1)</sup> To comply with the operation and electrical features, the bridging links must be assembled to the switch. Please consult.

## Technical information



According to IEC60947-1  
 IEC60947-3

			500	630
Rated thermal current in ambient at	I <sub>th</sub> 40° C	A	500	630
	50° C	A	500	630
	60° C	A	500	630
Rated insulation voltage DC20	U <sub>i</sub>	V	1500	1500
Rated impulse withstand voltage	U <sub>imp</sub>	kV	12	12
Rated operational current DC21B	I <sub>e</sub> U <sub>e</sub>	A 1500 Vdc	500	630

Short - circuit behaviour			
Maximum cut - off current <sup>*(1)</sup>	I <sub>cm</sub>	kA (peak)	26
Short - time withstand current (1 sec.)	I <sub>cw</sub>	kA rms	16
Mechanical features			
Number of mechanical operations (according to the standards, for other values please consult)	Cycles		5000
Maximum weight (without jumpers)	Kg		13

<sup>\*(1)</sup> Without limiting protective device (short-circuit maintained 50... 100 ms.)

## Connection diagram

### Connection diagram



### Bridging links<sup>\*(p1)</sup>

Front switch      Rear switch

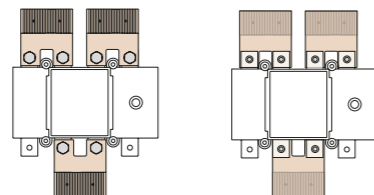
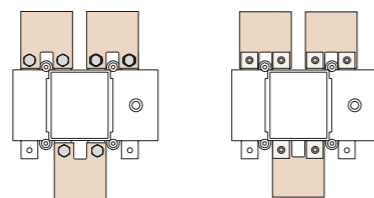

**CONSULT FOR GROUNDED INSTALLATIONS**

## Dimensions (mm)

Door drilling for external handle

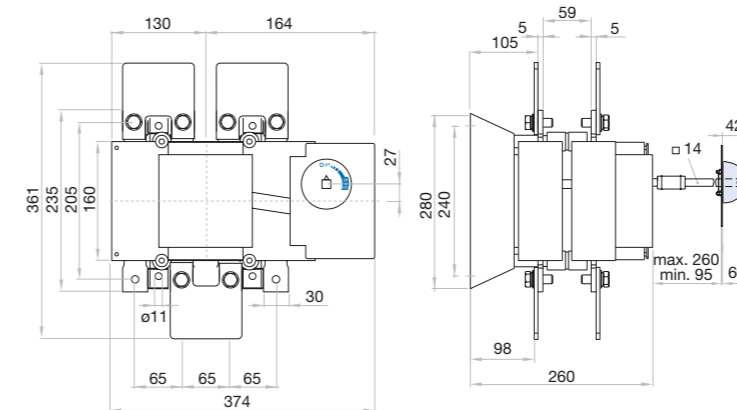
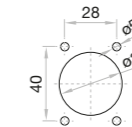

**500A**

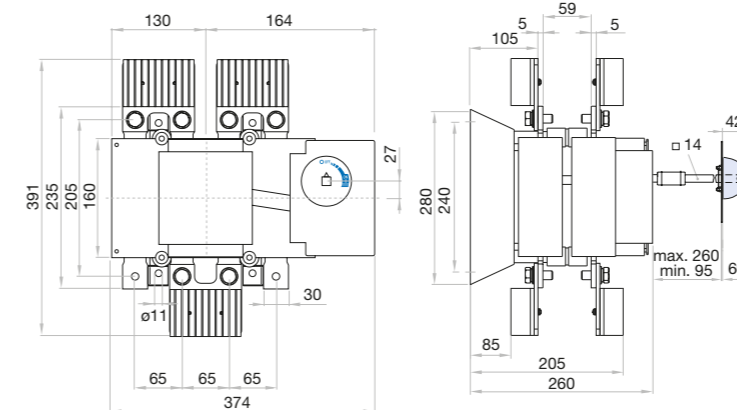

**630A**

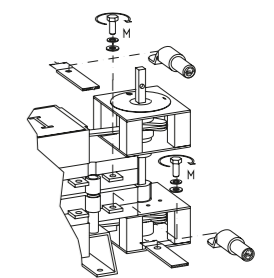

S max (Cu)	H max (Cu)	L max (Cu)	T	M
mm <sup>2</sup>	mm	mm		Nxm
2x240	2x5	40	M10	24

# S5M DC Switch - disconnecter for DC current 4P+4P

**Size 3**

**A** 800|1000

1500Vdc

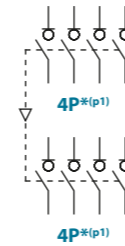

## Technical information



According to IEC60947-1  
IEC60947-3

		800		1000	
Rated thermal current in ambient at	lth 40° C	A	800	1000	
	50° C	A	800	1000	
	60° C	A	800	1000	
Rated insulation voltage DC20	Ui	V	1500	1500	
Rated impulse withstand voltage	Uimp	kV	12	12	
Rated operational current DC21B	le Ue 1500Vdc	A	800	1000	

\*<sup>(1)</sup> Without limiting protective device (short-circuit maintained 50... 100 ms.)

Short - circuit behaviour			
Maximum cut - off current * <sup>(1)</sup>	Icm	kA (peak)	60
Short - time withstand current (1 sec.)	Icw	kA rms	25
Mechanical features			
Number of mechanical operations (according to the standards, for other values please consult)	Cycles		3000
Maximum weight (without jumpers)	Kg		28,6

tests:



## Accessories



» Direct handle  
CODE DS-LI41



» External handle included shaft \*<sup>(e1)</sup>  
IP65  
CODE DS-LA41



» External handle without shaft  
IP65  
CODE DS-LA43

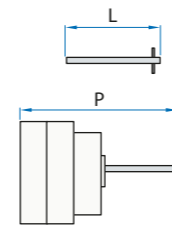

## » Shafts

Standard shaft included \*<sup>(e1)</sup>

L (mm)	P (mm)
239	408... 573



» Auxiliary contacts  
1NO+1NC CODE DS-AU11  
2NO+2NC CODE DS-AU12  
Ie = 16 A (resistive loads)  
4 A (inductive loads) at 250 Vac.



» Bridging links \*<sup>(p1)</sup>  
CODE DS-PI3D (2 units)

\*<sup>(p1)</sup> To comply with the operation and electrical features, the bridging links must be assembled to the switch. Please consult.

## Connection diagram

Connection diagram



Bridging links \*<sup>(p1)</sup>

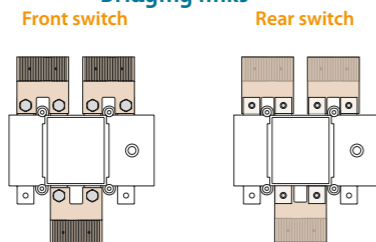

CONSULT FOR GROUNDED INSTALLATIONS

## Dimensions (mm)

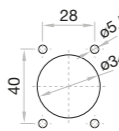
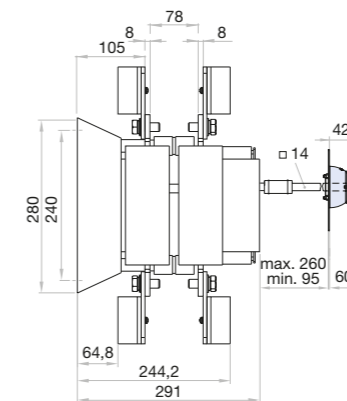
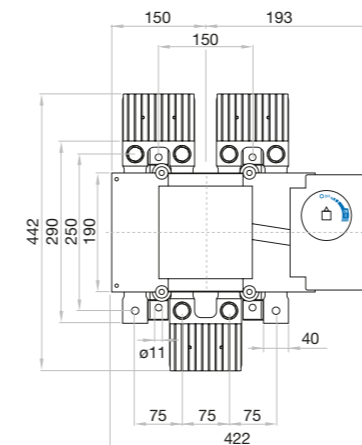

Door drilling for external handle

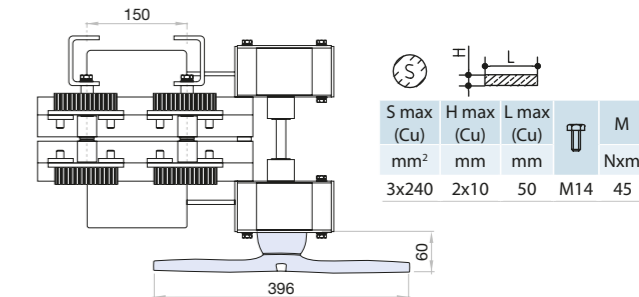
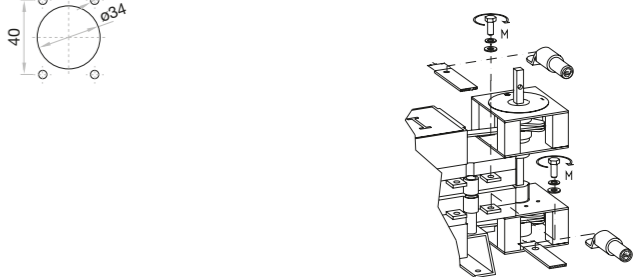

S max (Cu)	H max (Cu)	L max (Cu)	M
mm <sup>2</sup>	mm	mm	Nxm
3x240	2x10	50	M14 45



# S5N DC Switch - disconnecter for DC current 4P + 4P

**Size 4**  
**A 1250|1800**  
 1500Vdc

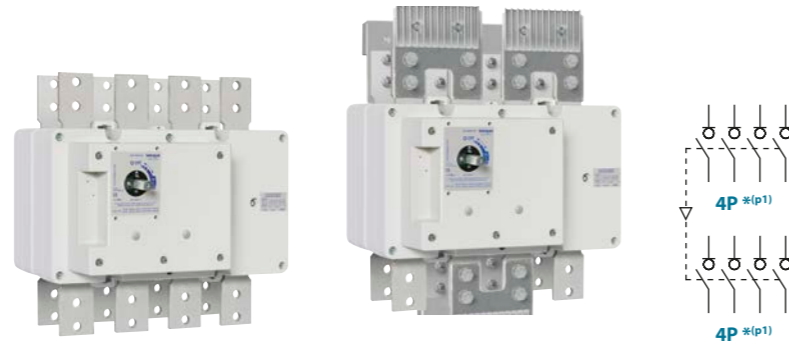

CODE - 1250A   
**SSN160044S0**

CODE - 1800A   
**SSN180044S0**

## Technical information



According to IEC 60947-1  
 IEC 60947-3

		1250		1800	
Rated thermal current in ambient at	lth	40° C	A	1250	1800
		50° C	A	1250	1800
		60° C	A	1250	1800
Rated insulation voltage DC20	Ui	V	1500	1500	
Rated impulse withstand voltage	Uimp	kV	12	12	
Rated operational current DC21B <sup>*(1)</sup>	Ue				
	Ie	1500 Vdc	A	1250	1800

<sup>\*(1)</sup> Other voltages and / or utilization categories. Please consult  
<sup>\*(2)</sup> Without limiting protective device (short-circuit maintained 50... 100 ms.)

Short - circuit behaviour			
Short - circuit making capacity <sup>*(2)</sup>	Icm	kA (peak)	60
Short - time withstand current (1 sec.)	Icw	kA rms	50
Mechanical features			
Number of mechanical operations (according to the standards, for other values please consult)	Cycles		600
Maximum weight (without bridging links)	Kg		44,3

**CONSULT FOR GROUNDED INSTALLATIONS**

## Connection diagram

### Connection diagram

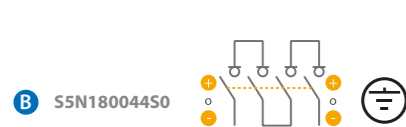

### Bridging links <sup>\*(p1)</sup>

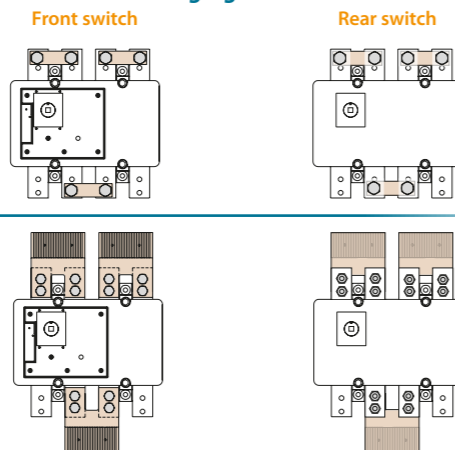

**MOTORIZED KIT AVAILABLE**  
**KIT UM**  
 PLEASE CONSULT

## Accessories



**Direct handle**  
 CODE DS-LI41



**External handle** included shaft <sup>\*(e1)</sup>  
 IP65  
 CODE DS-LA41



**External handle** without shaft  
 IP65  
 CODE DS-LA43

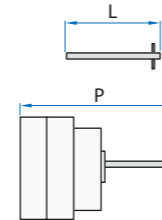

**Shafts**  
**Standard shaft** included <sup>\*(e1)</sup>  
 L (mm) | P (mm)  
 239 | 420 ... 580



**Auxiliary contacts**  
 1NO+1NC CODE D5LAU01  
 2NO+2NC CODE D5LAU02  
 Ie = 16 A (resistive loads)  
 4 A (inductive loads) at 250 Vac



**Bridging links <sup>\*(p1)</sup>**  
**A** 1250A CODE DS-PI430U (3 units)  
**B** 1800A CODE DS-PI4D (2 units)

<sup>\*(p1)</sup> To comply with the operation and electrical features, the bridging links must be assembled to the switch. Please consult

## Dimensions (mm)

