

S5 DC ISOLATION ONLY DC Disconnectors 1P

Size 2
A 1600
1500 Vdc



CODE-1600A S5-08004ZCOP38



Accessories



» Direct handle
CODE DS-LI21T



» Auxiliary contacts
1NO+1NC CODE D5LAU01
2NO+2NC CODE D5LAU02
I_e = 16 A (resistive loads)
4 A (inductive loads) at 250 Vac.

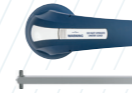

» External handle included shaft^{*(e1)}
IP65
CODE DS-LA21T



» Terminal protection
CODE DS-CU22
(1 unit for input or output)



» External handle without shaft
IP65
CODE DS-LA24T

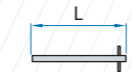

» Shafts
Standard shaft included^{*(e1)}
L (mm) | P (mm) |
195 | 134.. 240 |

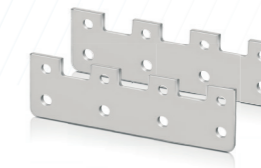

» Bridging links^{*(P2)}
CODE DS-PI2H (2 units)
^{*(P2)} To comply with the operation and electrical features, the bridging links must be assembled to the switch. Please consult.

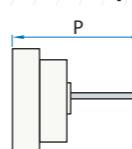

Shaft extensions
Type 1
L (mm) | P (mm) | CODE
345 | 134.. 400 | DS-EP23
Type 2
L (mm) | P (mm) | CODE
535 | 134.. 560 | DS-EP24

Technical information



DO NOT OPERATE UNDER LOAD

According to IEC 60947-1
IEC 60947-3

		1600	
Rated insulation voltage DC	U _i	V	1500
Rated impulse withstand voltage	U _{imp}	kV	12
Rated operational current DC20A	I _e	U _e 1500 Vdc	A 1600

		1600	
Number of mechanical operations (according to the standards, for other values please consult)	Cycles		3000
Maximum weight (without bridging links)	Kg		4,5

Dimensions (mm)

Door drilling for external handle

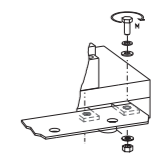
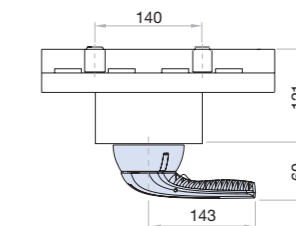
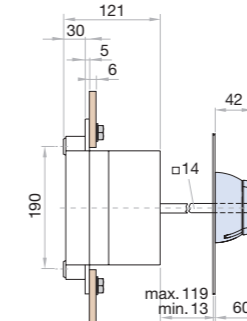
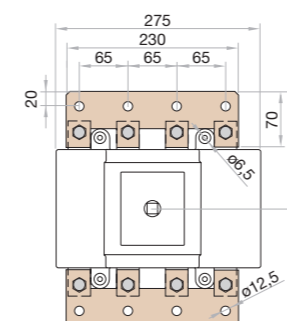
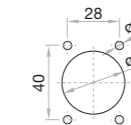

M	Nxm
M10	24

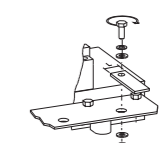

H max (Cu)	L max (Cu)
mm	mm
2x5	50

Connection diagram

Connection diagram

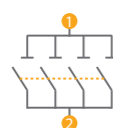

Bridging links ^{*(P2)}

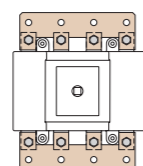

S5 DC ISOLATION ONLY DC Disconnectors

1P - 2P

Size 3

A 2200|2500

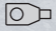

1500Vdc



2Z CODE - 2P - 2200A S5-12504ZCOP38



4Z CODE - 1P - 2500A S5-12504ZCOP38



Accessories



» Direct handle

CODE DS-LI31T



» External handle included shaft*(e1)

IP65
CODE DS-LA31T



» External handle without shaft

IP65
CODE DS-LA33T



» Auxiliary contacts

1NO+1NC CODE D5LAU01
2NO+2NC CODE D5LAU02

Ie = 16 A (resistive loads)
4 A (inductive loads) at 250 Vac.

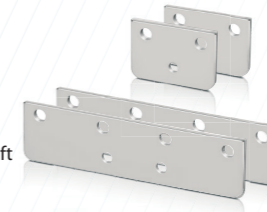

» Bridging links*(P2)

2Z 2200A CODE x2 DS-PI3L (2 units)
4Z 2500A CODE DS-PI3H (2 units)

*(P2) To comply with the operation and electrical features, the bridging links must be assembled to the switch. Please consult.

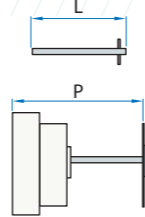

» Shafts

Standard shaft included *(e1)

L (mm)	P (mm)
186	145... 242

Shaft extensions

Type 1		CODE
L (mm)	P (mm)	DS-EP23
345	145... 411	

Type 2		CODE
L (mm)	P (mm)	DS-EP24
535	145... 600	

Technical information



DO NOT OPERATE UNDER LOAD

According to IEC 60947-1
IEC 60947-3

		2200	2500
Rated insulation voltage DC Ui	V	1500	1500
Rated impulse withstand voltage Uimp	kV	12	12
Rated operational current DC20A Ie	Ue 1500 Vdc A	2200	2500

	2200	2500
Number of mechanical operations (according to the standards, for other values please consult) Cycles	3000	3000
Maximum weight (without bridging links) Kg	7,6	7,6

Dimensions (mm)

Door drilling for external handle

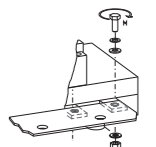
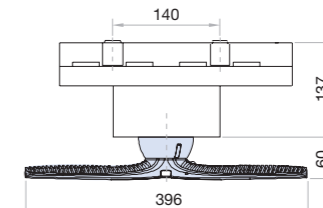
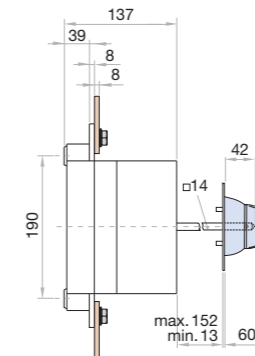
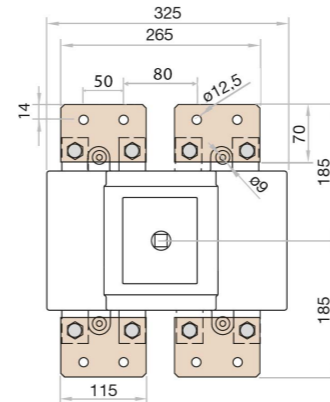
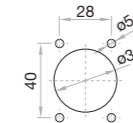

M Nm
M14 45

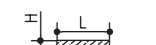
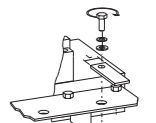

	H max (Cu) mm	L max (Cu) mm
2200A	2x10	100
2500A	3x10	100

Connection diagram

Connection diagram

Bridging links *(P2)

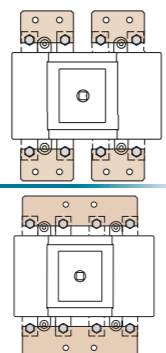
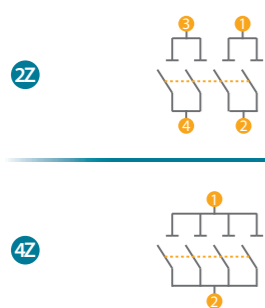

S5 DC ISOLATION ONLY DC Disconnectors 2P

Size 4
A 2500|3150

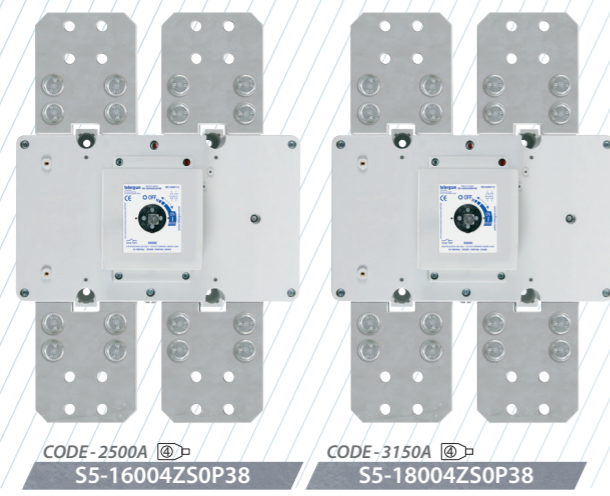
 1500Vdc



Accessories



» Direct handle
 CODE DS-LI41T

» External handle included shaft^{*(e1)}
 IP65
 CODE DS-LA41T

» External handle without shaft
 IP65
 CODE DS-LA43T



» Auxiliary contacts
 1NO+1NC CODE D5LAU01
 2NO+2NC CODE D5LAU02
 Ie = 16 A (resistive loads)
 4 A (inductive loads) at 250 Vac.



» Bridging links^{*(P2)}
 CODE x2 DS-PI4K (2 units)

^{*(P2)} To comply with the operation and electrical features, the bridging links must be assembled to the switch. Please consult.

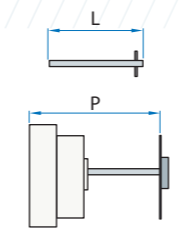

Shafts

Standard shaft included ^{*(e1)}
 L (mm) | P (mm)
 239 | 235... 400

Shaft extensions
 Type 1
 L (mm) | P (mm) | CODE
 485 | 235... 686 | DS-EP44

Type 2
 L (mm) | P (mm) | CODE
 635 | 235... 836 | DS-EP45

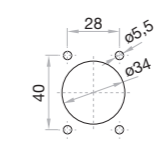

Dimensions (mm)

Door drilling for external handle

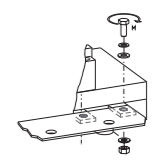
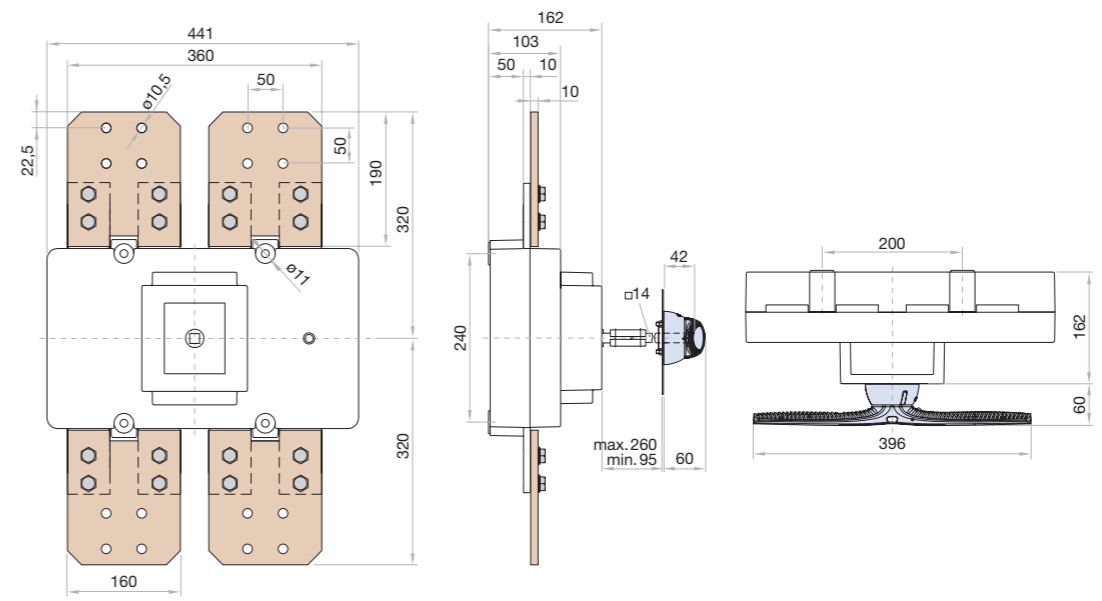

M
 Nxm
 M14 55

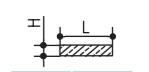
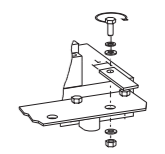

	H max (Cu) mm	L max (Cu) mm
2500A	2x5	100
3150A	3x5	100

Technical information



DO NOT OPERATE UNDER LOAD

According to IEC 60947-1
 IEC 60947-3

		2500	3150
Rated insulation voltage DC U _i	V	1500	1500
Rated impulse withstand voltage U _{imp}	kV	12	12
Rated operational current DC20A I _e	U _e 1500 Vdc A	2500	3150

	2500	3150
Number of mechanical operations (according to the standards, for other values please consult) Cycles	3000	2000
Maximum weight (without bridging links) Kg	20,8	20,8

Connection diagram

Connection diagram

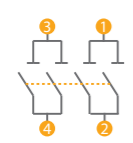

Bridging links ^{*(P2)}

